

Disclaimer

- This product is a pharmaceutical product approved under a Japanese law, the Law for Ensuring the Quality, Efficacy and Safety of Drugs and Medical Devices, with a view to its sale and use in Japan.
- Multilingual product information is a translation of the product labeling written in Japanese and provided for your information only. It does not warrant that its contents and the product itself conforms to laws and regulations in countries other than Japan.
- Multilingual product information is a tentative translation by Our Company, and may be modified or altered without notice.
- Our Company assumes no responsibility for any occurred problem attributable to the contents of the multilingual product information.

Hyalein[®]S

Hyalein S can be used while wearing any type of contact lenses except colored contact lenses.

Soft

O₂

Hard

Disposable

People not wearing contact lenses can use this eye drop.

*Because some eye drops cannot be used while wearing soft contact lenses, read the instructions on the package or package insert carefully.

Precautions for use

What not to do

(If you do not follow instructions, current symptoms may worsen or side effects are more likely to occur.)

The following people should not use this product.

- (1) People who have experienced allergic reactions to this product or any of its ingredients
 - (2) People who have received the following diagnoses: Dry eye, Sjögren syndrome, Stevens-Johnson syndrome, and corneal infection
 - (3) People who have the following symptoms: Sudden visual deterioration and severe pain in the eye(s)
- (Do not administer any treatment on your own judgment because symptoms may worsen. Please see a doctor for a diagnosis.)



Consultation

1. The following people should consult with their doctor or pharmacist **before using this product**.
 - (1) People receiving treatment by a doctor
 - (2) People who have experienced an allergic reaction to medicine or other substances
 - (3) People who have the following symptoms in addition to symptoms of the eyes:
 - Drying of mouth and drying of nasal cavity
 - High fever, lip erosion, pharyngeal pain, persistence of or sudden worsening of widespread rash/redness on the skin
 - (4) People who have received the following diagnosis: Glaucoma
2. If you experience any of the following symptoms **after using this product**, it may be a side effect. In such a case, stop using the product immediately, take this information sheet to your doctor or pharmacist, and seek consultation.

Affected area	Symptom
Skin	Rash/redness, itching
Eye(s)	Hyperemia, itching, swelling, pain, irritation, foreign body sensation, eye discharge

3. In any of the following cases, please stop using the product, take this information sheet to your doctor or pharmacist, and seek consultation.
 - (1) Blurring of eyes does not improve.
 - (2) Symptoms do not improve within approximately 1 week of use in accordance with Dosage and Administration (when you are about to finish up the first bottle), or any abnormalities are found. (Please seek consultation before you start to use the second bottle.)
4. Even with improvement of symptoms, seek consultation with your doctor or pharmacist if you continue to use the product for more than 2 weeks.

Indications

Mitigation of the following eye symptoms: Drying, foreign body sensation (gritty and prickling sensations), tiredness, blurring, and discomfort while wearing soft or hard contact lenses

Dosage and Administration

Instill one drop into affected eye(s) 5 to 6 times daily.

•Follow the precautions below.

- (1) If used for a child, the product must be administered under the instruction and supervision of the child's guardian.
- (2) Do not let the eyedropper tip touch the eyeball, eyelids, or eyelashes. (If eye discharge or bacteria get mixed in the solution, it may be contaminated or turbid.) Also, do not use the turbid solution.
- (3) Use the product as an eye drop only.
- (4) Do not use the product when you are wearing colored contact lenses.

How to open the cap

Twist the cap until it touches the shoulder of the bottle.

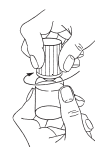

A hole is opened in the tip of the bottle.



Ingredients and quantity

Ingredients	Quantity
Purified sodium hyaluronate	0.1%

This product contains the following excipients: Aminocaproate, Disodium Edetate Dihydrate, Chlorhexidine Gluconate Solution, tonicity agent, and pH adjuster

Precautions for Storage and Handling

- (1) Do not twist the cap onto the bottle until you use the product.
- (2) Store in a cool place away from direct sunlight and keep sealed. To preserve the product quality, do not leave it in a hot place such as inside a car or near a heater. If the product is left in a hot place, the bottle may get deformed resulting in leakage or degradation of the solution. Do not use the product in such a condition.
- (3) Keep the product out of children's reach.
- (4) Do not transfer the solution to another container. (Misuse of the product or alteration of the product quality may occur.)
- (5) Do not share the product with anyone.
- (6) Do not use expired medicine. Use the product as soon as possible after opening it even if it is before the expiry date.
- (7) Depending on the storage condition, the ingredients may crystallize and white deposits can form around the eyedropper tip or inside the cap. In such a case, gently wipe off the deposits with a clean gauze before use.

