

Disclaimer

- This product is a pharmaceutical product approved under a Japanese law, the Law for Ensuring the Quality, Efficacy and Safety of Drugs and Medical Devices, with a view to its sale and use in Japan.
- Multilingual product information is a translation of the product labeling written in Japanese and provided for your information only. It does not warrant that its contents and the product itself conforms to laws and regulations in countries other than Japan.
- Multilingual product information is a tentative translation by Our Company, and may be modified or altered without notice.
- Our Company assumes no responsibility for any occurred problem attributable to the contents of the multilingual product information.

Sante FX AL

⚠ Precautions for use

⊗ Things to avoid

(Not observing the following precautions may aggravate present symptoms or cause adverse reactions and accidents.)

1. Do not use the product if you are one of the following people.
People who have experienced an allergic reaction to this medicine or any of its ingredients
2. If using this product concomitantly with nasal drops, do not attempt to operate a vehicle or machinery after use. (Use may cause drowsiness.)



Consultation

1. The following people should consult with their doctor, pharmacist, or registered pharmaceutical distributor before using this product.
 - (1) Anyone receiving treatment from a doctor
 - (2) Anyone undergoing allergy treatment such as desensitization therapy
 - (3) Anyone who is pregnant or possibly pregnant
 - (4) Anyone who has experienced an allergic reaction to medicine or other substances
 - (5) Anyone with the following symptom: Severe eye pain
 - (6) Anyone who has received the following diagnosis: Glaucoma
 - (7) Anyone for whom it is unclear whether their symptoms are due to allergy or some other cause
In any of the following cases in particular, as symptoms may not necessarily be due to allergy, please consult with your doctor before using the product.
 - If you have symptoms in one eye only
 - If you have symptoms in your eyes only, with no symptoms in your nose
 - If symptoms also affect your vision

2. If you experience any of the following symptoms after using this product, it may be an adverse reaction. In such a case, please stop using the product immediately, take this information form to your doctor, pharmacist, or registered pharmaceutical distributor and seek consultation.

Area affected	Symptom
Skin	Rash/redness, itchiness
Eye(s)	Redness, itchiness, swelling, pain

Although rare, the following serious symptoms have been known to occur. In such a case, please seek medical treatment from a doctor immediately.

Name of symptom	Symptom
Shock (Anaphylaxis)	Itchiness of the skin or hives, hoarseness of the voice, sneezing, itchiness in the throat, difficulty breathing, palpitation, clouding of consciousness, etc. immediately after use

3. In any of the following cases, please stop using the product, take this information form to your doctor, pharmacist, or registered pharmaceutical distributor and seek consultation.
 - (1) If blurriness of the eyes does not improve
 - (2) If symptoms do not improve within 2 days of use
4. Even if you see improvement of symptoms, take this information form to your doctor, pharmacist, or registered pharmaceutical distributor and seek consultation if using the product for more than 2 weeks.

Dosage / Administration

Instill 1 to 2 drops at a time, 4 to 6 times daily.

[Precautions regarding dosage and administration]

- (1) Observe the prescribed dosage and administration
- (2) If administered to a child, the product must be administered under the direction and observation of the child's guardian.
- (3) Do not let the tip of the bottle touch your eyes, eyelids or eyelashes (doing so could cause the solution to become contaminated with eye mucus or bacteria). Do not use the product if it does become contaminated.
- (4) Do not use the product while wearing contact lenses.
- (5) Use only as an eye drop.



How to open the twist cap

Please be sure to open the cap when the bottle is upright.

Note: If you open the bottle while squeezing it in the middle, it may cause the solution to squirt from the bottle.



● **Opening the bottle**
Grasp and twist the cap with your whole thumb.

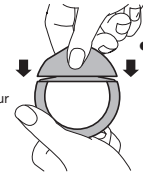

● **Closing the cap**
Press down firmly until it stops.

Indication

Relief of the following eye allergy symptoms caused by pollen or house dust: Itchy eyes, red eyes, blurry eyes (increase in eye mucus, etc.), teary eyes, sensation of foreign body (gritty feeling)

Ingredients and quantity

Ingredients	Quantity	Action
Sodium cromoglicate	1.0%	Suppresses congestion and itchiness of the eyes by suppressing the release of substances such as histamine.
Chlorpheniramine maleate	0.03%	Suppresses inflammation and itchiness of the eyes by suppressing histamine activity.
Epsilon-aminocaproic acid	1.0%	Suppresses production of substances that cause inflammation.
Taurine	1.0%	Activates cell metabolism of eye tissue.
Potassium L-aspartate	1.0%	Increases tissue respiration in the eyes.

This product contains the following excipients: edetate sodium hydrate, chlorbutanol, benzalkonium chloride, d-camphor, d-borneol, l-menthol, and pH-adjusting agent.

Precautions regarding storage and handling

- (1) Store in a cool place away from direct sunlight and keep sealed. To preserve the quality of the product, do not leave it in a hot place such as inside a car or near a heater. If the product is left in a hot place, the vials may become warped causing the solution to leak and degrading its quality. Please do not use the product in such a case.
- (2) Keep out of reach of children.
- (3) Do not transfer the solution to another receptacle. (Doing so may lead to misuse of the product or may affect its quality.)
- (4) Do not share the product with another person.
- (5) Do not use the product if it has exceeded its use-by date. Even before the use-by date, please use the product as soon as possible after opening the bottle.
- (6) Depending on the conditions of storage, the ingredients may crystallize and form white deposits around the inside of the bottle's tip or on the inside of the cap. If this occurs, gently wipe off the deposits with a clean piece of gauze before using the product.

